

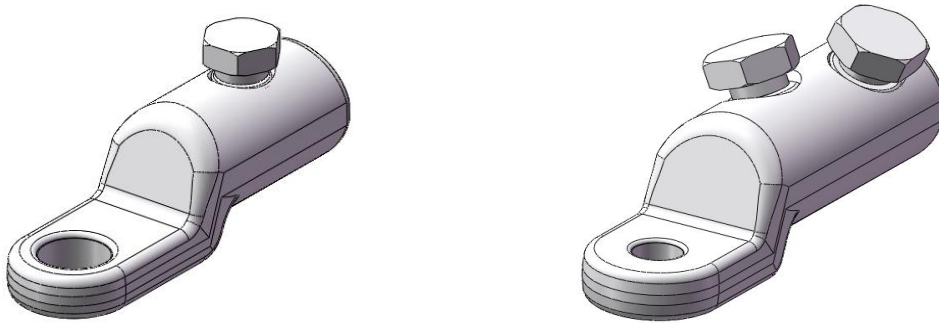







Shear Bolt Connector-Installation Instruction

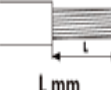

Product Range (Model)	 mm ² Al Conductor Round	 mm ² Al Conductor Sector	 mm ² Cu Conductor Round	 mm ² Cu Conductor Sector	 L mm Stripping Length	 Mount Insert	 Remove Insret	 A/F mm Bolt Across Flat
AUL25-95	25-95	25-70	25-95	25-70	35	25-50	70-95	13
AUL35-150	35-150	35-150	35-150	35-150	41	35-70	95-150	17
AUL70-240	70-240	70-185	70-240	70-185	64	70-120	150-240	19
AUL120-300	120-300	120-240	120-300	120-240	71	120-185	240-300	22
AUL185-400	185-400	185-300	185-400	185-300	81	185-240	300-400	22
AUL300-400	---	---	---	---	---	---	---	---
AUL400-630	---	---	---	---	---	---	---	---

Note: Different conductor material should be tested according to IEC 61238-1 given parameters.

Shear Bolt Connector-Installation Instruction

Installation Procedures

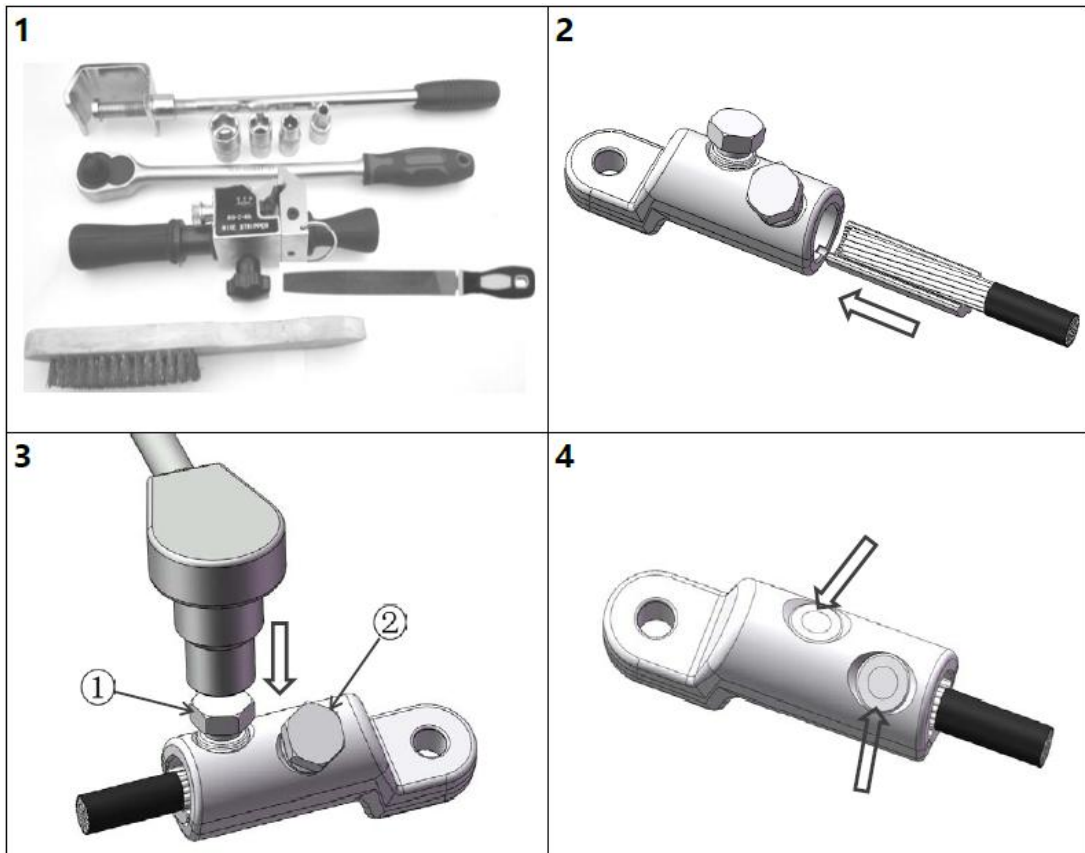

Installation Steps:

1. Select the matching shear bolt connector and installation tools according to the type and size of Conductor as shown on the table (see photo 1);
2. Strip conductor insulation according to the specified length;
3. Remove the oxide layer on the conductor surface with a brush. Then apply contact grease provided in the shear bolt connector and insert the conductor into shear bolt connector immediately (see photo 2);
4. Hand-tighten all bolts to fix the conductor at the center of the shear bolt connector;
5. Use a torque wrench to tighten the bolt slowly until the shear point breaks away. Tighten the bolts in the sequence of 1 and 2 and 3 as shown in photo 3 (Tighten bolts out-side-in);
6. Once the bolt shears off, use a file to even out all the sharp edges (see photo 4).

In as much as CHARDON GROUP, Inc. has no control over the use which others may put the material, it does not guarantee that the same results as those described herein will be obtained. Each user of the material should make his own tests to determine the material's suitability for his own particular use. Statements concerning possible uses of the materials described herein are not to be construed as constituting a license under any CHARDON GROUP, inc. patent covering such use or as recommendations for use of such materials in the infringement of any patent.





FOR FURTHER INFORMATION WRITE TO

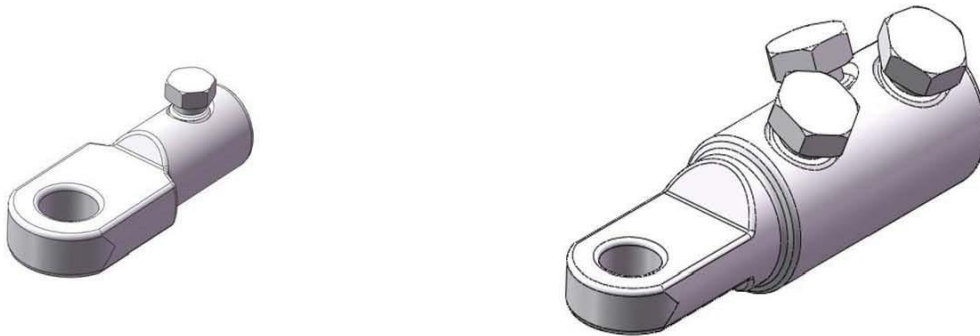

sales@chardongroup.com

Shear Bolt Connector-Installation Instruction

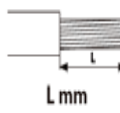
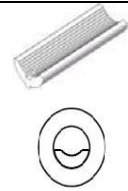
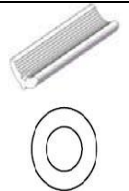
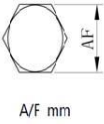

Product Range (Model)	 Al Conductor Round	 Al Conductor Sector	 Cu Conductor Round	 Cu Conductor Sector	 Stripping Length	 Mount Insert	 Remove Insret	 Bolt Across Flat
AULZ25-95/1	25-95	25-70	25-95	25-70	35	25-50	70-95	13
AULZ70-240/2	70-240	70-185	70-240	70-185	64	70-120	150-240	19
AULZ185-400/3	185-400	185-300	185-400	185-300	81	185-240	300-400	22

Note: Different conductor material should be tested according to IEC 61238-1 given parameters.

Shear Bolt Connector -Installation Instruction

Installation Procedures

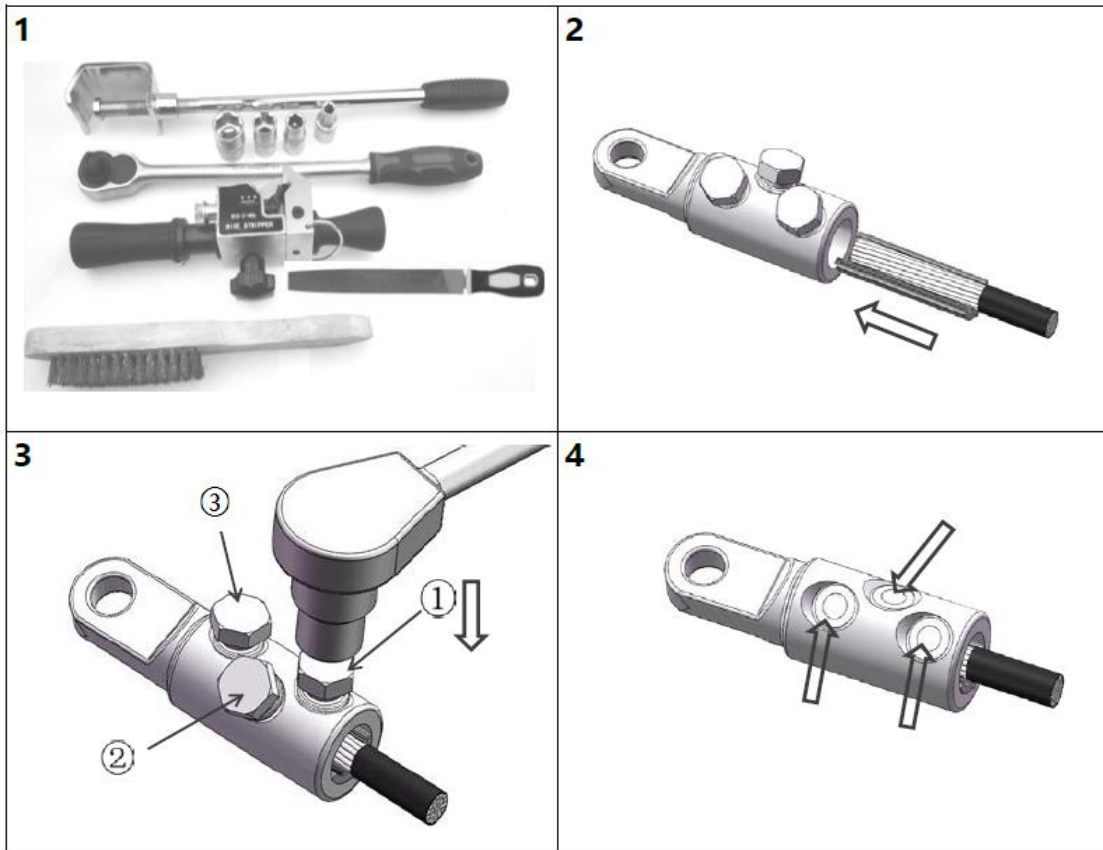

Installation Steps:

1. Select the matching shear bolt connector and installation tools according to the type and size of Conductor as shown on the table(see photo 1);
2. Strip conductor insulation according to the specified length;
3. Remove the oxide layer on the conductor surface with a brush. Then apply contact grease provided in shear bolt connector and insert the conductor into shear bolt connector immediately(see photo 2);
4. Hand-tighten all bolts to fix the conductor at the center of the shear bolt connector;
5. Use a torque wrench to tighten the bolt slowly until the shear point breaks away. Tighten the bolts in. The sequence of 1 and 2 and 3 as shown in photo 3(Tighten bolts out-side-in);
6. Once the bolt shears off, use a file to even out all the sharp edges(see photo 4).

In as much as CHARDON GROUP, Inc. has no control over the use which others may put the material, it does not guarantee that the same results as those described herein will be obtained, Each user of the material should make his own tests to determine the material's suitability for his own particular use. Statements concerning possible uses of the materials described herein are not to be construed as constituting a license under any CHARDON GROUP, inc. patent covering such use or as recommendations for use of such materials in the infringement of any patent.

FOR FURTHER INFORMATION WRITE TO



sales@chardongroup.com